

ROTISSERIE MasterFlame GAS
MF975.2G.SS or 975.2G.LUX

TOP VIEW

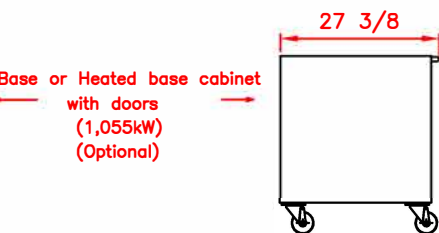
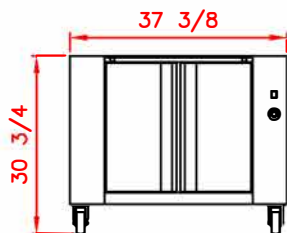
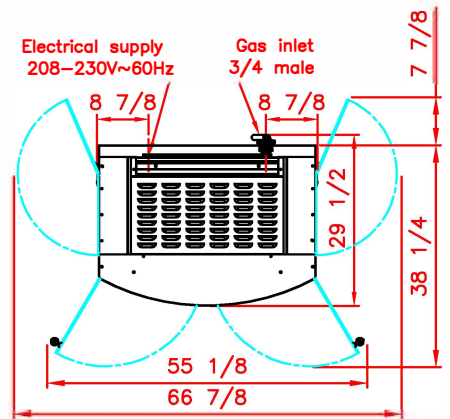

SPECIFICATIONS

All stainless steel with brass or chrome for rotisserie ref: MF975.2G.SS

2 adjustable spits + alternative system of vertical spits with 3 hooks integrated

Electrical supply: 230Volts 1 phase+neutral+earth (110V), 3.34 Amps , wire length 6' Electric power 0.368 kW made up of:

_4 ventilators of 20 W, 1 halogen lamp of 150 W

OPTIONS: Enamel specific color ref: COUL 1, alternative engine ref: AM20. base cabinet ref: 9SRL, 9SRiL or 9SRS, heated base cabinet with doors ref: 9SCL, 9SCiL or 9SCS (1.055 kilowatts to add to the electric power of the rotisserie), heated base cabinet with drawers ref: 9SBCL, 9SBCiL or 9SBCS (1.055 kilowatts to add to the electric power of the rotisserie).

All this information are the property of Rotisol. Reproduction partial or in totality are prohibited without authority prior written of compagny Rotisol.